

RESOLUTION NO. 1996-146

AUTHORIZING THE ACCEPTANCE BY THE GREATER CLEVELAND
REGIONAL TRANSIT AUTHORITY FROM THE CITY OF EAST
CLEVELAND OF FEE SIMPLE TITLE TO A PARCEL OF REALTY
LOCATED AT 14209 EUCLID AVENUE

WHEREAS, the City of East Cleveland, has proposed that it gift a parcel of realty located in East Cleveland, Ohio, to the Greater Cleveland Regional Transit Authority for the purpose of implementing the Authority's Livable Communities project; and

WHEREAS, the Authority will benefit from the acceptance of such gift from the City of East Cleveland, and thus desires to accept the gift of realty.

NOW, THEREFORE, BE IT RESOLVED by the Board of Trustees of the Greater Cleveland Regional Transit Authority that:

Section 1: The proposal of the City of East Cleveland, to make a gift of a parcel of realty located at 14209 Euclid Avenue also known as Hatton's Building and designated as Permanent Parcel No. 672-12-016 to the Greater Cleveland Regional Transit Authority for the purpose of the Authority developing a Head Start Center.

Section 2: The General Manager be and is hereby directed to execute on behalf of the Authority all documents necessary to effectuate this transaction.

Section 3: This resolution shall become effective immediately upon its adoption by the Board of Trustees.

Attachment: Parcel Map

Adopted: October 15, 1996

Attachments:

Attest: 
General Manager/Secretary Treasurer

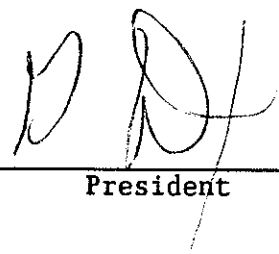

President

GREATER CLEVELAND REGIONAL TRANSIT AUTHORITY

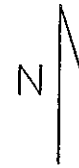
REAL ESTATE INVENTORY

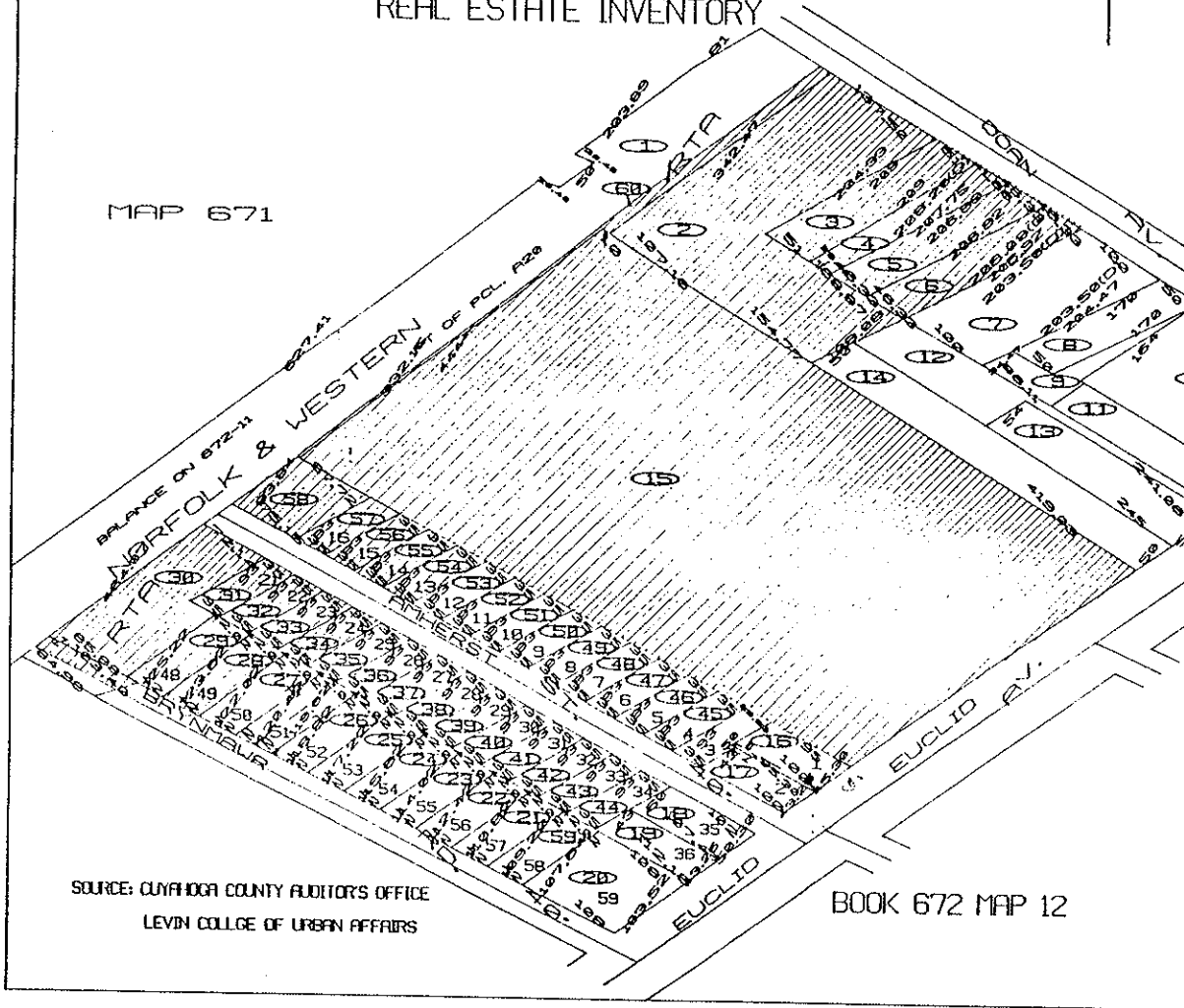

MAP 671



SOURCE: CUYAHOGA COUNTY AUDITOR'S OFFICE
LEVIN COLLEGE OF URBAN AFFAIRS

BOOK 672 MAP 12

Subject